

THE STAR CASINO Gold Coast, Australia

Project Exclusive

The Star Gold Coast redevelopment delivers a vibrant entertainment environment with elevated design, integrated services and high-volume visitor traffic.

ASP supplied access flooring systems engineered to support large gaming areas, hospitality spaces and back-of-house operations requiring durability and long-term stability.

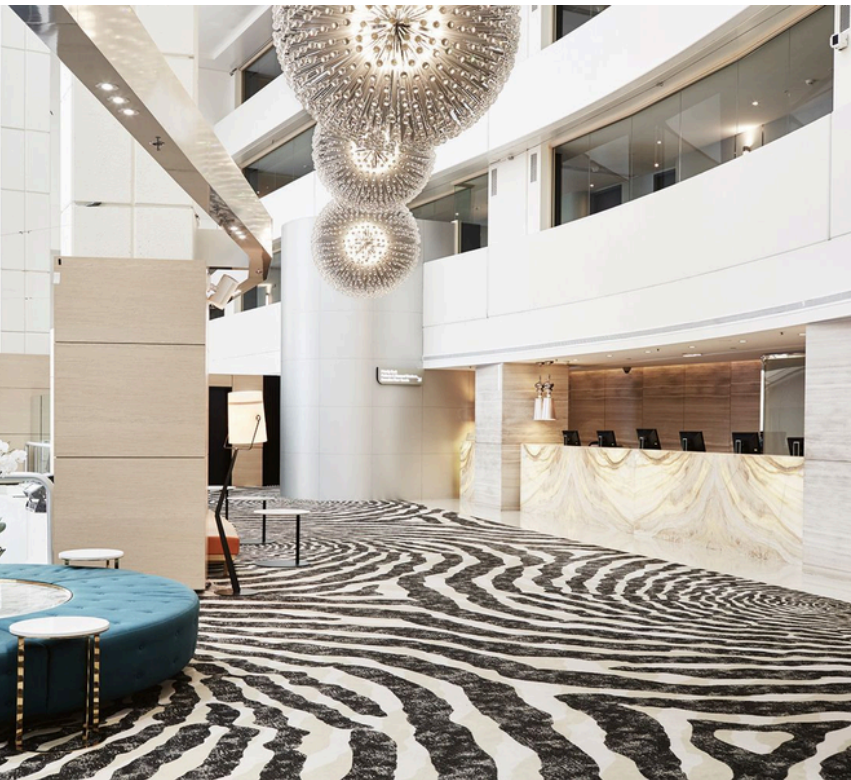

THE WHO'S WHO

CLIENT

The Star

ARCHITECT

Buchan Group

BUILDER

Probuild

ACCESS FLOOR INSTALLATION

ASP Access Floors



THE ACCESS FLOOR SCOOP

ASP supplied a combination of ICON HD and Urban Interlock systems to meet the demanding performance requirements of casino floor environments. ICON HD was installed across 3,995 m2 (43,000 sqft) to support heavy rolling loads, dynamic foot traffic and complex service integration beneath the floor.

Urban Interlock was applied across a further 1,208 m2 (13,000 sqft) to support areas requiring acoustic control and seamless transitions to high-finish floor surfaces.

Together, these systems create a flexible, accessible and high-strength foundation that supports gaming equipment, back-of-house services and future reconfiguration as operational needs evolve.



SUSTAINABILITY TRENDS



AUSTRALASIA **EPD**[®]
ENVIRONMENTAL PRODUCT DECLARATION



greenstar

DID YOU KNOW

The system installation supports material efficiency and long-term durability, aligning with modern construction standards for commercial entertainment facilities.

3,995 m2 (43,000 sqft) - ICON HD
1,208 m2 (13,000 sqft) - Urban Interlock

ICON HD is engineered specifically for heavy-duty environments such as gaming floors, where long-term load performance is critical.

Featured Products

ICON HD

High-strength access floor system engineered for heavy rolling loads and durability.

URBAN INTERLOCK

Gypsum-core access flooring providing acoustic performance and compatibility with hard finishes.